

AERODROME CHART - ICAO

532114N 0021630W

ELEV 257FT

MANCHESTER EGCC

LIGHTING	
THR 05L/23R THR 05R/23L	HI green with HI green W bars. HI green with HI green W bars.
RWY 05L/23R RWY 05R/23L	HI bi-d edge. HI colour coded C/L. End lights red. TDZ 914m. Elev HI bi-d with LI omni-d component. End lights red.
TWY	Green C/L, blue edge on sharp curves. Red stop bars at holding points. TWY's Alpha and Juliet green/yellow lead-off C/L to CAT III stop bars.

COM			
ARRIVAL ATIS	128.175	MANCHESTER INFO	
DEPARTURE ATIS	121.975	MANCHESTER DEPARTURE INFO	
TWR	118.625	119.400	MANCHESTER TOWER
	121.850	125.375	MANCHESTER GROUND
	121.700		MANCHESTER DELIVERY
	121.600		MANCHESTER FIRE

GUND (Geoid Undulation) = The height of the Geoid (MSL) above the Reference Ellipsoid (WGS 84) at the stated position.	
BEARINGS ARE MAGNETIC ELEVATIONS AND HEIGHTS ARE IN FEET	
ELEVATIONS IN FEET AMSL	390 (133)
HEIGHTS IN FEET ABOVE AD	(133)

VAR 3.2°W - 2007
Annual Rate of Change 0.15°E

RUNWAY/APRON PHYSICAL CHARACTERISTICS		
APRON / RWY	SURFACE	BEARING STRENGTH
RWY 05L/23R	Concrete/Grooved Asphalt	94/F/C/W/T
RWY 05R/23L	Concrete/Grooved Asphalt	79/R/C/W/T
Main	Concrete	56/R/C/W/T
Main	Concrete	97/R/B/W/T

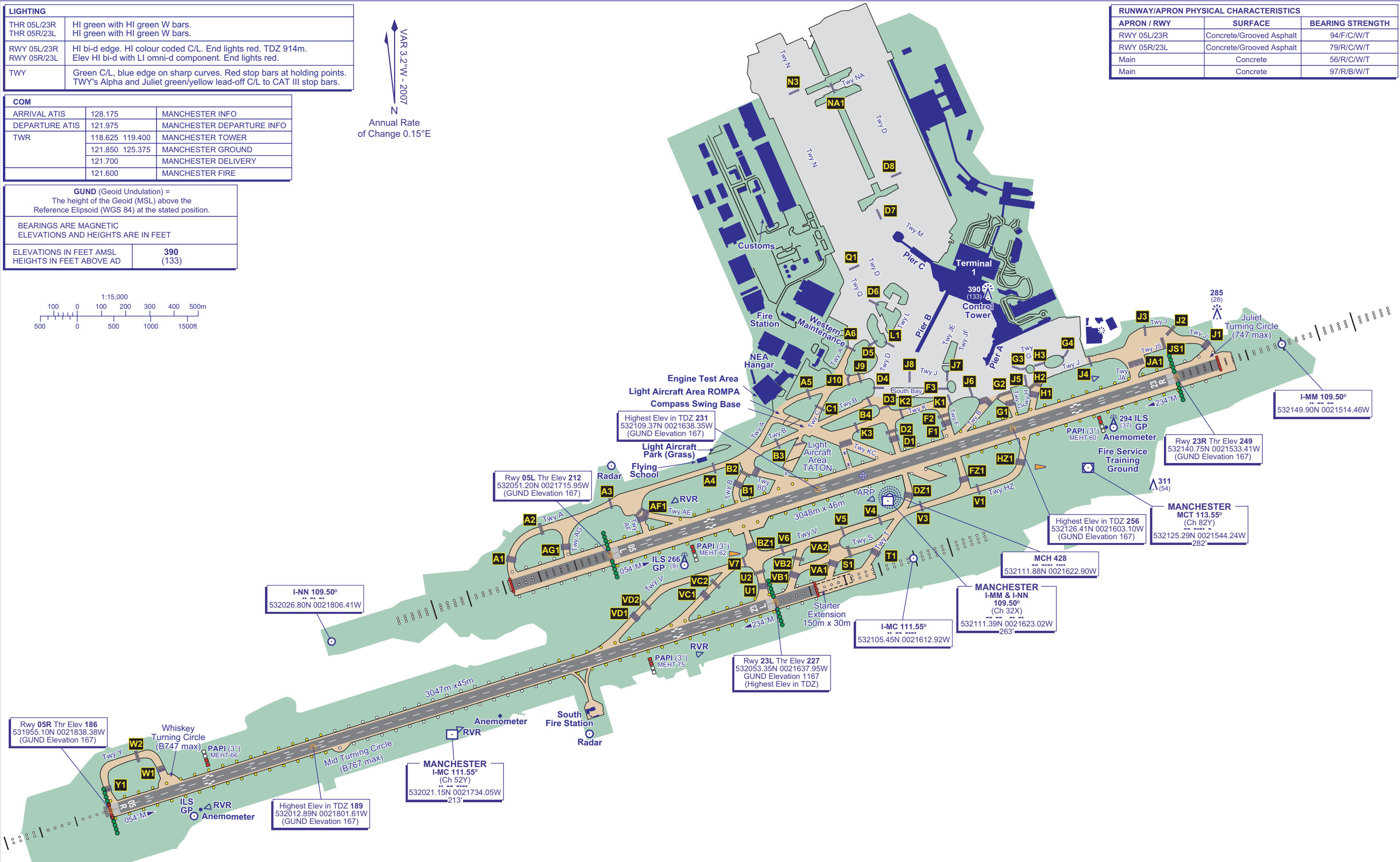
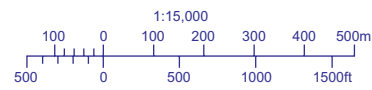

CHANGE: HOLDS BZ2/DZ2/FZ2/HZ2 REDESIGNATED BZ1/DZ1/FZ1/HZ1. HOLD NA1 REPOSITIONED. HEL AIMING POINT/TWY S EXTENSION REMOVED. FLYING SCHOOL/RADAR ADDED. HOLDS V7/V6/V5/V4/V3/V1/A3/A4/A5/A6/B3/B4/C1/D3/D4/D5/D6/D7/D8/F3/L1/Q1/NA1/N3/J10/J9/J8/J7/J6/J5/J4/J3/G3/G4/H3/K1/K2/K3 NOW INTERMEDIATE.

AERO INFO DATE 27 JUN 07

Civil Aviation Authority

AMDT 9/07